



23×16.1×10(1A)
22.3×16.6×11(1C)

NT76

UL E174722 R50126372

Features

- Super light in weight.
- High sensitivity.
- Switching capacity up to 16A.
- PC board mounting.

Ordering Information

NT76 A S **12VDC**
1 2 3 4

1 Part number: NT76
2 Contact arrangement: A:1A; C:1C
3 Enclosure: S: Wash tight; Z: Flux proof

4 Coil rated voltage(V): DC:5,6,9,12,18,24,48

Contact Data

Contact Arrangement	1A(SPSTNO) 1C(SPDT(B-M))		
Contact Material	AgSnO ₂		
Contact Rating	1A: 16A/250VAC, 30VDC;1C: NO:16A/250VAC, 30VDC NC:10A/250VAC,30VDC TüV 16A/250VAC,14VDC		
Max. Switching Power	480W 4000VA		
Max. Switching Voltage	30VDC 277VAC	Max. Switching Current:16A	
Contact Resistance	≤50mΩ	Item 4.12 of IEC 61810-7	
Operational Life	Electrical	1×10 ⁵	Item 4.30 of IEC 61810-7
	Mechanical	1×10 ⁷	Item 4.31 of IEC 61810-7

CAUTION: 1.For the intermediate current, it only applies to the room temperature.

Coil Parameter

Dash numbers	Coil voltage VDC		Coil resistance Ω ± 10%	Pick-up voltage VDC(max) (75%of rated voltage)	Drop-out voltage VDC(min) (5% of rated voltage)	Coil power W	Operate time ms	Release time ms
	Rated	Max.						
1A								
005-200	5	6.5	125	3.75	0.25	0.20	≤10	≤5
006-200	6	7.8	180	4.50	0.30			
009-200	9	11.7	405	6.75	0.45			
012-200	12	15.6	720	9.00	0.60			
018-200	18	23.4	1620	13.5	0.90			
024-200	24	31.2	2880	18.0	1.20			
1C								
005-450	5	6.5	56	3.75	0.25	0.45	≤10	≤5
006-450	6	7.8	80	4.50	0.30			
009-450	9	11.7	180	6.75	0.45			
012-450	12	15.6	320	9.00	0.60			
018-450	18	23.4	720	13.5	0.90			
024-450	24	31.2	1280	18.0	1.20			
048-450	48	52.8	5120	38.4	2.40			

Characteristics

Insulation Resistance	100M Ω min (at 500VDC)	Item 4.11 of IEC 61810-7
Dielectric Strength Between Contacts Between Contact and Coil	50Hz 1000V 1C:50Hz 1500V;1A:50Hz 2500V	Item 4.9 of IEC 61810-7 Item 4.9 of IEC 61810-7
Shock Resistance	98m/s ² 11ms	Item 4.26 of IEC 61810-7
Vibration Resistance	10Hz~55Hz Double amplitude 1.5mm	Item 4.28 of IEC 61810-7
Terminals Strength	10N	Item 4.24 of IEC 61810-7
Ambient Temperature	-40 $^{\circ}$ C~85 $^{\circ}$ C	
Relative Humidity	85%(at 20 $^{\circ}$ C)	Item 4.16 of IEC 61810-7
Mass	10g	Item 4.7 of IEC 61810-7

Safety Approvals

Safety approval	UL&CUR	TUV
Load	1A:16A/250VAC;1C: 10A/250VAC	16A/250VAC, 14VDC

Dimensions

mm

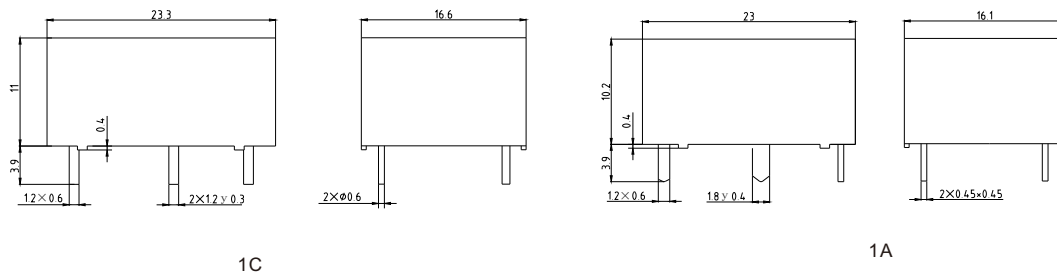

Dimensions



Mounting (Bottom view)

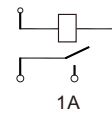
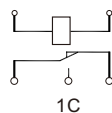

Wiring diagram(Bottom view)

CAUTION: In case of no tolerance shown in outline dimension: outline dimension ≤ 1 mm, tolerance should be ± 0.2 mm ; outline dimension > 1 mm and ≤ 5 mm, tolerance should be ± 0.3 mm; outline dimension > 5 mm, tolerance should be ± 0.4 mm.