

Feature

- Comply with RoHS requirements.
- Operating temperature range: 0°C to +70°C.
- Storage temperature range: -25°C to +105°C.

Electrical Specifications @ 25°C

OCL:	51 uH±30%. @1KHz/1V
Hi-Pot :	500VAC 3mA 3Sec
Turns Ratio:	1:1±3%
LK:	(1-4) short (2.3) =2.0uH Typ @100KHz/0.1V
DCR:	0.16ohm Max
IR:	800mA

Schematic

Mechanical

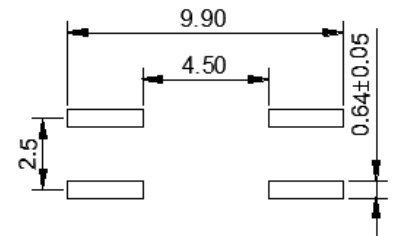
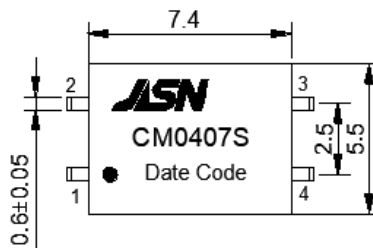
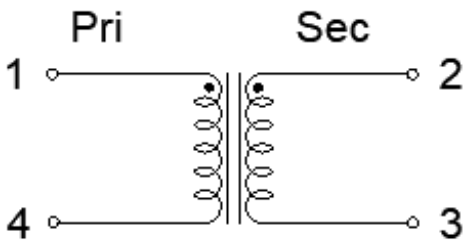

SUGGESTED PAD LAYOUT

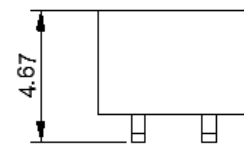
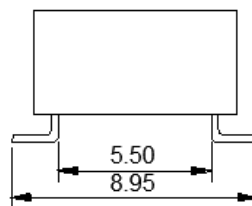

Unless otherwise specified, all tolerances are ±0.25mm