

Hot And Cold Water Booster Pump



Model:Pm

YINJIA Pump is a professional surface clean water pump manufacturer in China since 1990, has specialized in manufacturing various of surface clean water pumps, as well as providing quality hot and cold water booster pump for the world. We are committed to providing high quality product at a competitive price and backed up with superior service. Welcome to inquiry for hot and cold water booster pump.

Pm series hot and cold water booster pump belongs to the single-phase self-priming peripheral pump category, is a best seller pump in the global market. It is our patent design pump, attractive appearance, compact and very silent. The pump is assembled with very resistant and durable materials which is able to guarantee a very high solidity and the almost total absence of wear over time. Pumps should be installed in a covered area, protected against the weather.

Product Feature And Application

• APPLICATIONS

- Suitable for use with clean water, or non-aggressive liquids only, without sand or other solid impurities.
- Suitable for small living water supply, automatic water sprinkler system, small air conditioner system or supporting equipment etc.

• DESIGN FEATURES

- Pump body/motor bracket: cast iron
- Impeller: Brass
- 100% copper winding
- Built-in thermal protector for single phase motor
- Motor shaft: AISI 304 welded shaft
- Mechanical seal: Graphite/Ceramic/NBR/S.S304

• SPECIAL FEATURES ON REQUEST

- Anti-rust treatment for casting
- No block system
- AISI 1045 motor shaft
- Carbon/SiCA/ mechanical seal
- Other voltage and frequency
- Insulation class: F

• OPERATING LIMITS

- Total suction lift up to 6-8 mt. with foot valve
- Max. operating pressure: 8 bar.
- Max. ambient temperature: +40 °C
- Max. liquid temperature: +90 °C
- Max. altitude: +1000 mt.

- MOTOR**
 - Insulation class: B
 - Protection: Ip44
 - Speed of rotation: 2850rpm
 - Continuous duty: S1

Product Parameter (Specification)

PERFORMANCE

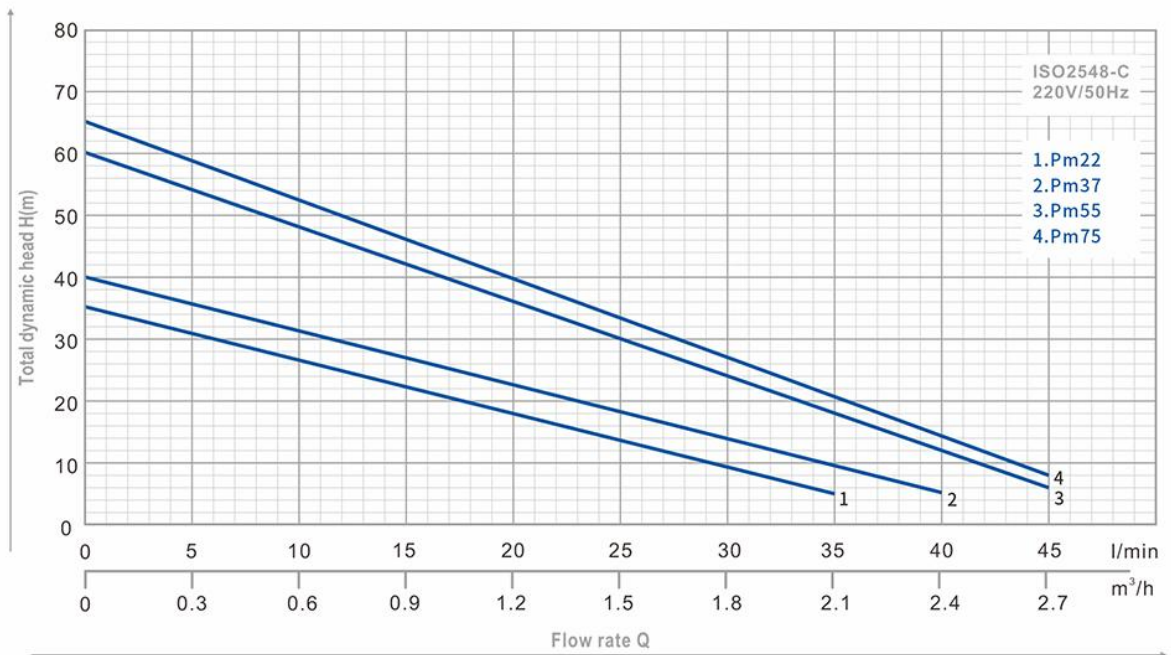

TYPE	Power		μF	Ampere I max.	Q l/min m³/h	0	5	10	20	30	35	40	45	DN1	DN2	N.W (kg)	Package Dimension (mm)		
	HP	kW				0	0.3	0.6	1.2	1.8	2.1	2.4	2.7				L	W	H
Pm22	0.3	0.22	8	1.9	H (m)	35	31	27	18	10	5	-	-	1"	1"	6.5	275	195	250
Pm37	0.5	0.37	12	2.8		40	36	31	22	14	10	5	-	1"	1"	7	275	195	250
Pm55	0.75	0.55	16	3.7		60	54	48	36	24	18	12	6	1"	1"	10	300	205	285
Pm75	1.0	0.75	20	4.5		65	59	52	40	27	21	14	8	1"	1"	11	300	205	285

Pm22 - 0.22 kW / 0.3 HP - Max. Head 35m - Max. Flow 35 l/min - 1" water pump
Pm37 - 0.37 kW / 0.5 HP - Max. Head 40m - Max. Flow 40 l/min - 1" water pump
Pm55 - 0.55 kW / 0.75 HP - Max. Head 60m - Max. Flow 45 l/min - 1" water pump
Pm75 - 0.75 kW / 1 HP - Max. Head 65m - Max. Flow 45 l/min - 1" water pump

DIMENSIONS

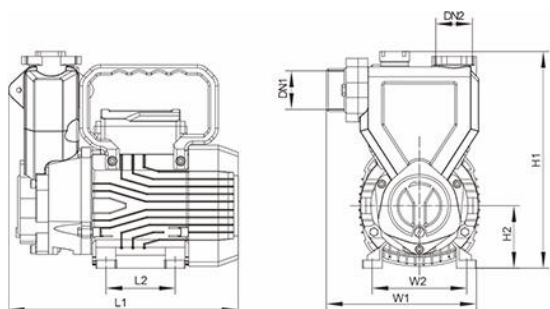

TYPE	L1	W1	H1	L2	W2	H2
Pm22	232	155	218.5	90	99	63
Pm37	232	155	218.5	90	99	63
Pm55	258	198	278	103	105	71
Pm75	258	198	278	103	105	71

PM EXPLODING DRAWING

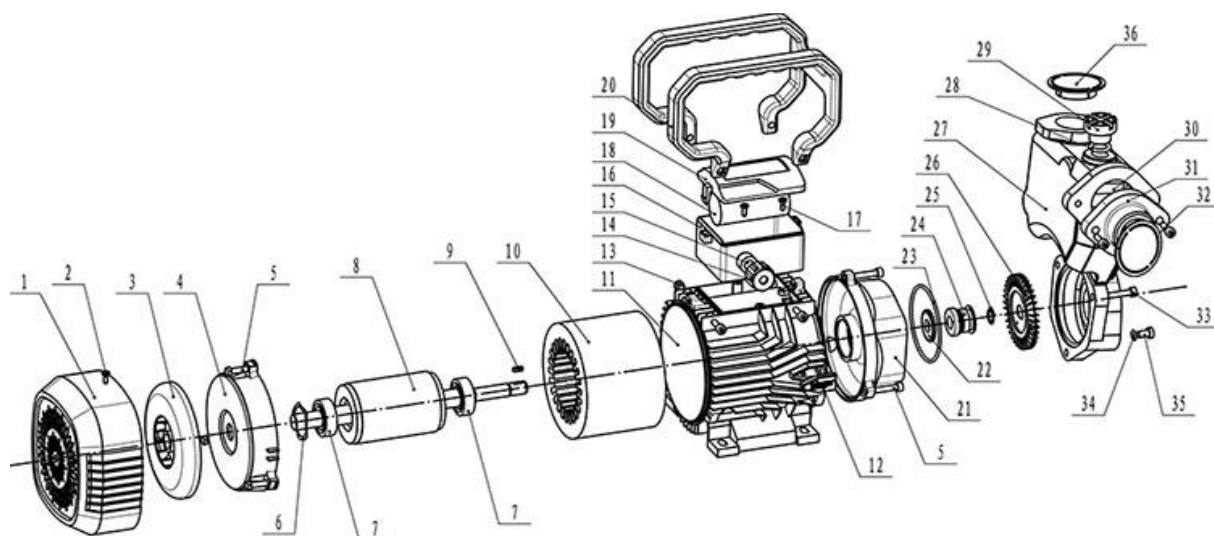

Ser.No.	Part Name	Ser.No.	Part Name	Ser.No.	Part Name	Ser.No.	Part Name
1	fan cover	11	motor housing	21	front cover	31	flange
2	Screw	12	logo	22	splash guard	32	bolt
3	fan	13	bolt	23	o ring	33	bolt
4	back cover	14	cable hood	24	mechanical seal	34	o ring
5	bolt	15	Rubber Washer	25	washer	35	screw
6	spring washer	16	terminal box seat	26	brass impeller	36	plastic cover
7	bearing	17	screw	27	pump body		
8	rotor	18	capacitor	28	o ring		
9	shaft key	19	terminal box cover	29	brass plug		
10	sator	20	handle	30	check valve		