

# K

## Machine Accessories

Boring Tool  
**BJ00 306**

Lathe Quick Center Block  
**ETHR0000 306**

Centre-Drill Holder  
**ECH 307**

Sleeve  
**SHB 308**

**EHR 309**

**EHR-O 311**

**EHRMT 312**

ER Collet Chuck  
**EKA 312**

EC-ER Collet Nut  
**EC-ER 313**

**NEW** ER Wrench  
**ER 313**

ER Collet  
**ER 314**

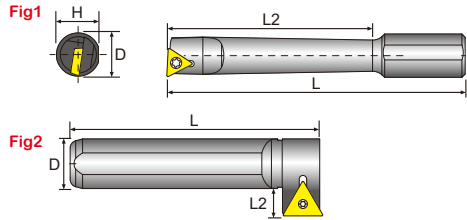

**BJ00** Boring Tool

Model No	Stock	D	H	L	L2	Range	Fig	Insert	Screw	Wrench	Price
BJ2008-32	●	20	18	80	32	8-10	1	TB□□0601□□	CS20	T-6	
BJ2010-40	●	20	18	87	40	10-12	1				
BJ2012-53	●	20	18	98	53	12-16	1	TP□□0902□□	CS25	T-8	
BJ2016-68	●	20	18	110	68	16-20	1				
BJ2020-83	●	20	18	122	83	20-25	1	TP□□1103□□	CS30	T-10	
BJ2025-96	●	20	18	133	96	25-30	1				
BJ2030-115	●	20	18	152	115	30-35	1				
BJ-L20-36	●	20	18	100	8	—	2				

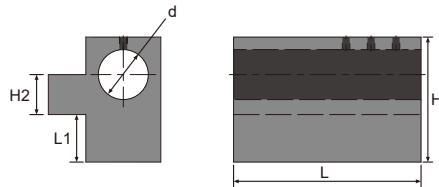

**ETHR0000** Lathe Quick Center Block

Model No	Stock	d	H	H2	L	L1	Screw	Wrench	Price
ETHR2032	●	32	64	20	80	18	ES-808	LW040	
ETHR2532	●	32	64	25	80	18			
ETHR2040	●	40	76	20	90	30	ES-810		
ETHR2540	●	40	76	25	90	30			
ETHR3240	●	40	76	32	90	30			

Boring Tool / Lathe Quick Center Block

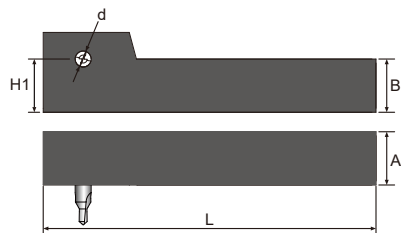
**ECH** Centre Drill Holder  
Shank : Steel

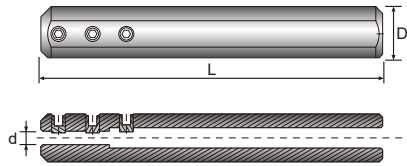

Model No	Stock	d	A	B	H1	L	Fig	Screw	Wrench	Price
										
ECH-2020K05	●	5	20	20	20	125	1	ES-410	LW020	
ECH-2020K06	●	6	20	20	20	125	1	ES-510	LW025	
ECH-2020K08	●	8	20	20	20	125	1	ES-610	LW030	
ECH-2020K10	●	10	20	20	20	125	1	ES-810	LW040	
ECH-2020K12	●	12	20	20	20	125	1			
ECH-2525M05	●	5	25	25	25	150	2	ES-410	LW020	
ECH-2525M06	●	6	25	25	25	150	2	ES-510	LW025	
ECH-2525M08	●	8	25	25	25	150	1	ES-610	LW030	
ECH-2525M10	●	10	25	25	25	150	1	ES-810	LW040	
ECH-2525M12	●	12	25	25	25	150	1			

**SHB** SHB Sleeve  
 Shank : Steel

Model No	Stock	d	D	H	L	Assembly Holder	Screw	Wrench	Price
SHB-0316	●	3	16	15	100		ES-306	LW015	
SHB-0416	●	4	16	15	100	C04	ES-404	LW020	
SHB-0516	●	5	16	15	100	C05			
SHB-0616	●	6	16	15	100	C06			
SHB-0816	●	8	16	15	100	C08/S08	ES-606	LW030	
SHB-1016	●	10	16	15	100	C10/S10			
SHB-04-19.05	●	4	19.05	18.05	100	C04	ES-406	LW020	
SHB-05-19.05	●	5	19.05	18.05	100				
SHB-06-19.05	●	6	19.05	18.05	100				
SHB-08-19.05	●	8	19.05	18.05	100	C05	ES-606	LW030	
SHB-10-19.05	●	10	19.05	18.05	100				
SHB-12-19.05	●	12	19.05	18.05	100	C06			
SHB-0420	●	4	20	19	100	C08/S08	ES-404	LW020	
SHB-0520	●	5	20	19	100		ES-406		
SHB-0620	●	6	20	19	100	C10/S10	ES-606	LW030	
SHB-0820	●	8	20	19	100				
SHB-1020	●	10	20	19	100				
SHB-1220	●	12	20	19	100	C12/S12			
SHB-0422	●	4	22	21	100	C04	ES-406	LW020	
SHB-0522	●	5	22	21	100	C05	ES-404		
SHB-0622	●	6	22	21	100	C06	ES-406		
SHB-0822	●	8	22	21	100	C08/S08	ES-606	LW030	
SHB-1022	●	10	22	21	100	C10/S10			
SHB-1222	●	12	22	21	100	C12/S12			
SHB-1622	●	16	22	21	100	C16/S16			

●Holder Refer Page-171-220

**EHR** EHR Sleeve  
Shank : Steel

New Specification Arrival

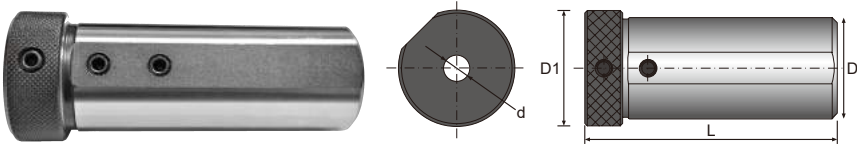

Fig	Model No	Stock	d	D	D1	L	Screw	Price
	EHR-0625	●	6	25	34	64	ES-606	
	EHR-0825	●	8	25	34	64		
	EHR-1025	●	10	25	34	64		
	EHR-1225	●	12	25	34	64		
	EHR-1625	●	16	25	34	64	-	
	EHR-2025	●	20	25	34	64		
	EHR-06-25.4	●	6	25.4	34	64	ES-606	
	EHR-08-25.4	●	8	25.4	34	64		
	EHR-10-25.4	●	10	25.4	34	64		
	EHR-12-25.4	●	12	25.4	34	64		
	EHR-16-25.4	●	16	25.4	34	64	-	
	EHR-0632	●	6	32	38	100	ES-610	
	EHR-0832	●	8	32	38	100		
	EHR-1032	●	10	32	38	100	ES-810	
	EHR-1232	●	12	32	38	100		
	EHR-1632	●	16	32	38	100	ES-806	
	EHR-2032	●	20	32	38	100	ES-810	
	EHR-2532	●	25	32	38	100	ES-806	

※ Continued on next page.

Fig	Model No	Stock	d	D	D1	L	Screw	Price
								
	EHR-0640	●	6	40	46	100	ES-610	
	EHR-0840	●	8	40	46	100		
	EHR-1040	●	10	40	46	100	ES-810	
	EHR-1240	●	12	40	46	100		
	EHR1440	●	14	40	46	100		
	EHR-1640	●	16	40	46	100		
	<b>NEW</b> EHR-2040A	●	20	40	46	100		
	EHR-2040	●	20	40	46	100	ES-806	
	EHR-2540	●	25	40	46	100		
	EHR-3240	●	32	40	46	100		
	EHR-0650	●	6	50	58	100	ES-610	
	EHR-0850	●	8	50	58	100		
	EHR-1050	●	10	50	58	100	ES-810	
	EHR-1250	●	12	50	58	100		
	EHR-1650	●	16	50	58	100		
	EHR-2050	●	20	50	58	100	ES-810	
	EHR-2550	●	25	50	58	100		
	EHR-3250	●	32	50	58	100	ES-808	
	EHR-4050	●	40	50	58	100		

**EHR-O** 內徑出水套筒 材質：鋼  
Sleeve With Coolant Hole Shank : Steel

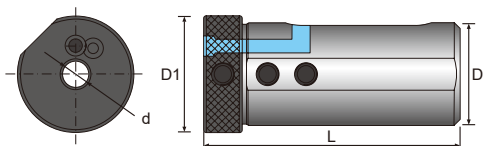
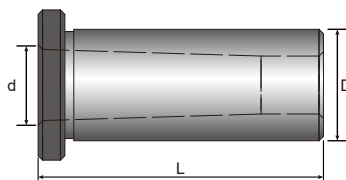
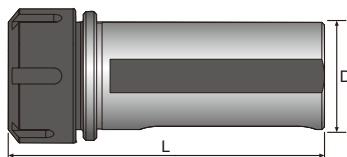

Fig	Model No	Stock	d	D	D1	L	Screw	EHR-O	Screw	Price
							ES-610		TS408	
	EHR-0632-O	●	6	32	38	100	ES-610	EHR-O	TS408	
	EHR-0832-O	●	8	32	38	100				
	EHR-1032-O	●	10	32	38	100	ES-810			
	EHR-1232-O	●	12	32	38	100				
	EHR-1632-O	●	16	32	38	100				ES-806
	EHR-0640-O	●	6	40	46	100	ES-610			
	EHR-0840-O	●	8	40	46	100				
	EHR-1040-O	●	10	40	46	100	ES-810			
	EHR-1240-O	●	12	40	46	100				
	EHR-1640-O	●	16	40	46	100				
	EHR-2040-O	●	20	40	46	100				

**EHRMT** EHRMT Sleeve  
 Shank : Steel

Model No	Stock	D	d	L	Price
EHRMT1-25	●	25	MT1	70	
EHRMT2-25	●	25	MT2	80	
EHRMT3-25	●	25	MT3	90	
EHRMT1-32	●	32	MT1	85	
EHRMT2-32	●	32	MT2	85	
EHRMT3-32	●	32	MT3	100	
EHRMT1-40	●	40	MT1	87	
EHRMT2-40	●	40	MT2	87	
EHRMT3-40	●	40	MT3	87	
EHRMT4-40	●	40	MT4	116	
EHRMT1-50	●	50	MT1	120	
EHRMT2-50	●	50	MT2	120	
EHRMT3-50	●	50	MT3	120	
EHRMT4-50	●	50	MT4	120	

**EKA** ER Collet Chuck  
 Shank : Steel

Model No	Stock	Capacity	D	L	Screw	Screw	Price
EKA-ER20-C32-120	●	2-13	32	120	ES-606	ES1225	
EKA-ER20-C40-120	●	2-13	40	120	ES-610		
EKA-ER25-C32-120	●	2-16	32	120	ES-606		
EKA-ER25-C40-120	●	2-16	40	120	ES-610		
EKA-ER32-C40-120	●	3-20	40	120			



## EC-ER EC-ER Collet Nut



Model No	Stock	Fig	D	H	M	Price
EC-ER16	●	2	28	18.7	22	
EC-ER20	●	2	34	21.7	25	
EC-ER25	●	1	42	23.8	32	
EC-ER32	●	1	50	25.2	40	

## ER ER Wrench

New Arrival

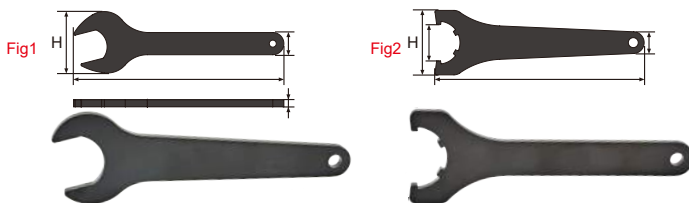

Model No	Stock	Fig	D	H	M	Price
ER-16A	●	1	28	18.7	22	
ER-20A	●	1	34	21.7	25	
ER-25A	●	2	42	23.8	32	
ER-32A	●	2	50	25.2	40	

ER Collet Nut / ER Wrench

**K**  
MACHINE  
ACCESSORIES

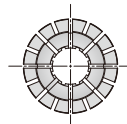
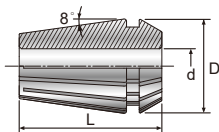
**ER** ER Collet

Model No	Stock	d	D	L	Price
ER-11	●	2、3、4、5、6	11.5	18	
ER-16	●	2、3、4、5、6、8、9、10	17	27	
ER-20	●	2、3、3.5、4、4.5、5、5.5、6、6.5、7、7.5、8、8.5、9、9.5、10、10.5、11、11.5、12、12.5、13	21	31	
ER-25	●	2、3、4、5、6、7、8、9、10、11、12、12.5、13、14、15、16	26	34	
ER-32	●	3、4、6、8、9、10、10.5、11、11.5、12、13、14、15、16、17、18、19、20	33	40	
ER-40	●	4、13、16、20、23、26	41	46	