

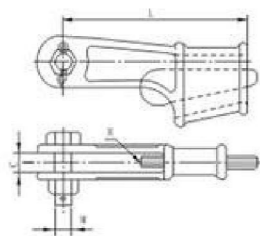

NX楔形线夹

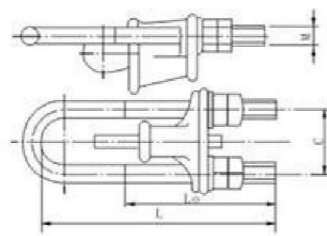

NUT线夹 (可调式)



NUT线夹

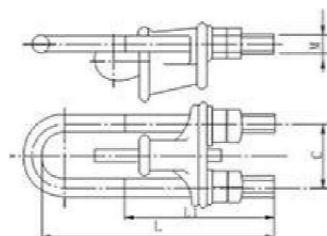

NUT线夹的参数 Parameters of UT connectors

型号 Type	钢绞线外径 Steel Wire Dia (mm)	主要尺寸 Dimensions(mm)				标称破坏荷重 Rated failure load(kN)	重量 Weight (kg)
		C	M	L	L1		
NUT-1	6.6-7.8	56	16	350	200	45	2.10
NUT-2	9.0-11.0	62	18	430	250	88	3.20
NUT-3	13.0-14.0	74	22	500	300	143	5.40
NUT-4	15.0-16.0	82	24	580	300	164	7.20

NU线夹的参数 Parameters of UT connectors

型号 Type	钢绞线外径 Steel Wire Dia (mm)	主要尺寸 Dimensions(mm)				标称破坏荷重 Rated failure load(kN)	重量 Weight (kg)
		C	M	L	L0		
NU-1	6.6-7.8	56	16	290	70	45	1.92
NU-2	9.0-11.0	62	18	290	70	88	2.61
NU-3	13.0-14.0	74	22	290	60	143	4.21
NU-4	15.0-16.0	82	24	340	70	164	7.27

楔形线夹的参数 Parameters of UT connectors

型号 Type	钢绞线外径 Steel Wire Dia (mm)	主要尺寸 Dimensions(mm)				标称破坏荷重 Rated failure load(kN)	重量 Weight (kg)
		C	M	L	R		
NX-1	6.6-7.8	18	16	150	6.0	45	1.19
NX-2	9.0-11.0	20	18	180	7.3	88	1.76
NX-3	13.0-14.0	24	24	200	7.3	143	3.20
NX-4	15.0-16.0	28	27	220	8.0	164	5.30

注：线夹的本身和楔子为可锻铸铁，热镀锌。闭口销为不锈钢铸件，其余为热镀锌钢制件。



JXL Series Clamp (wedge Type)

Application

The wedge connector is applicable for overhead line, connect solid and stranded aluminum, aluminum alloy and stranded aluminum composite aerial bundled conductors. Equipped with insulating cover

Application of wire clamp

Choosing the wedge clamps according to the model and section size of the main conductor and tap conductor.

Application of wire clamp

Figure 1: Wedge clamps cases are divided into four types, choose the installation tool follow the clamps case size. Choose the small installation tool for No.1 and No.2 case clamps, big size installation tool for No.3 and No.4 case clamps.

Figure 2: The installation tool is easy to operate, reliable and in good use.



JXL Insulation Cover (wedge Type)

Structure feature

Non-magnetic material, no power loss
Elastic clamping by the wedge, continuous and reliable
Suitable for various wires, strong applicability



图1：JXL楔形线夹安装工具
JXL installation tools of wedge type



图2：JXL楔形线夹智能安装工具
JXL Wedge insulating clamp intelligence the erecting



Wedge connector & Insulating Cover

Model	Section Size (mm ²)	
	Main Line	
JXL-1、1号壳体	95~50	16~95
	120~50	16~120
JXL-2、2号壳体	150	16~150
JXL-3、3号壳体	185	16~185
JXL-4、4号壳体	240	16~240