



Non-Rising Stem Resilient-Seated(NRS) Gate Valve(Grooved End)

Buy Non-Rising Stem Resilient-Seated(NRS) Gate Valve(Grooved End) which is of high quality directly with low price. We supply Non-Rising Stem Resilient-Seated(NRS) Gate Valve(Grooved End).The gate valve provides full flow with minimal pressure drop. The gate valve is designed to be the main control valve in an automatic fire sprinkler system. The gate valve

features a AWWA C606 Groove, grooved end connection for easy installation and accessibility. We are expecting to become your long term partner in China.

Product Description

As a professional high quality Hispeed® Non-Rising Stem Resilient-Seated(NRS) Gate Valve(Grooved End) manufacture, you can rest assured to buy Non-Rising Stem Resilient-Seated(NRS) Gate Valve(Grooved End) from our factory and we will offer you the best after-sale service and timely delivery.

Hispeed® Non-Rising Stem Resilient-Seated(NRS) Gate Valve(Grooved End)

The Hispeed® Non-Rising Stem Resilient-Seated(NRS) Gate Valve(Grooved End) is designed to be the main control valve in an automatic fire sprinkler system. The gate valve features a AWWA C606 Grooved, grooved end connection for easy installation and accessibility. We are expecting to become your long term partner in China.

Product Parameter (Specification)

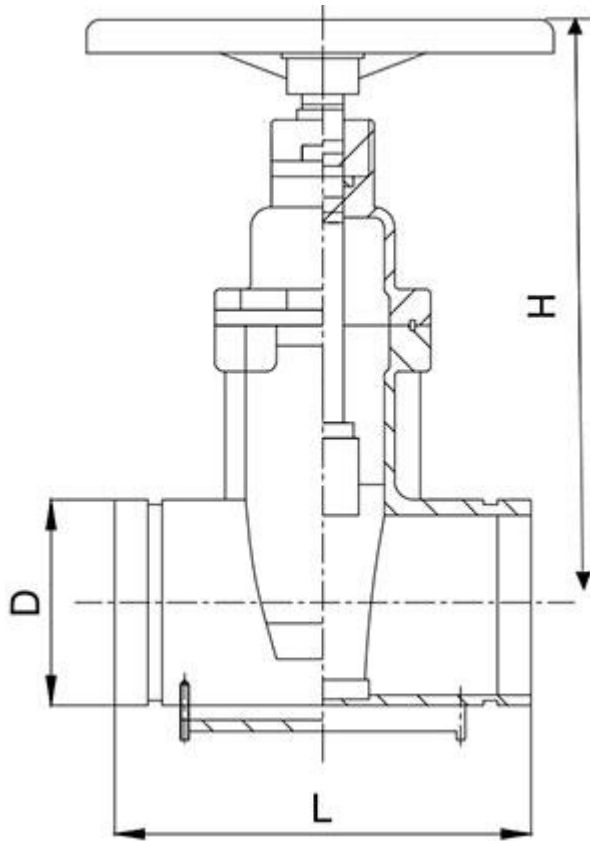

Size	2"		2.5"		3"		4"		5"		6"		8"		10"		12"	
	mm	inch	mm	inch	mm	inch	mm	inch	mm	inch	mm	inch	mm	inch	mm	inch	mm	inch
OD	60.3	2-3/8	73.0	2-7/8	88.9	3 1/2	114.3	4 1/2	139.7	5-1/2	165.1	6-1/2	219.1	8-5/8	273.0	10-3/4	323.9	12-3/4
L	178	7	190.5	7-1/2	203	8	229	9	254	10	267	10-1/2	292	11-1/2	330	13	356	14
H	261.5	8-1/2	270	10-5/8	296	11-5/8	350	13-3/4	410	16-1/8	455	17-15/16	545	21-7/16	645	25-3/8	730	28-3/4

Product Feature And Application

Meet or exceed AWWA C515

Full Waterway

Adjustable Packing

Ductile Iron Wedge, EPDM Encapsulated

Face to Face Dimensions to ANSI/ASME B16.10, EN558 S03

Groove ends to AWWA C606

300PSI

Fusion Bonded Epoxy Coated Interior and Exterior to AWWA C550 Standard

Product Details

Available with Supervisory Switch

ASTM B150 Bronze Stem Available

ASTM A276 Type 316/431/420 Stainless Steel Available

Part	Material	ASTM Specification
Body	Ductile Iron	A536 Grade 65-45-12
Wedge	EPDM Fully Encapsulated Ductile Iron	
Wedge Nut	Stainless Steel	A351 Grade CF8
Bonnet	Ductile Iron	A536 Grade 65-45-12
Yoke	Ductile Iron	A536 Grade 65-45-12
Stem	Stainless Steel	A276 Type 304
Stem Nut	Bronze	B148 C95200
Body/Bonnet Gasket	Rubber	D2000 EPDM
Packing	Graphite	Non-Asbestos
Gland	Ductile Iron	A536 Grade 65-45-12
Gland stud	Stainless Steel	F593 Grade 304
Bonnet Fasteners	Carbon Steel	A307 Grade B
Plug	Malleable Iron	A47 Grade 22010
Handwheel	Ductile Iron	A536 Grade 65-45-12

Deliver, Shipping And Serving

Ship from Qingdao or another Seaports

FAQ

	Q	A
1	How many days you need to install the equipment?	Unwanted.
2	How many staff abroad you sent to install the equipment?	Unwanted.
3	Can I transfer the money to you then you pay to other supplier?	YES.
4	Can I delivery the goods from other supplier to your factory? Then load together?	YES.
5	When will you leave your factory and to have your spring festival holidays?	According to national regulations.
6	Can the equipment be installed under hot weather?	YES.

7	Can Your products be installed under the cold weather?	YES.
8	Do You have office in shanghai or guangzhou that i can visit?	NONE.
9	Can you send your staff to install the equipment for us?	Unwanted.
10	Can I only buy some spare parts from you?	YES.
11	Will you will attend the fair to show your products?	YES.
12	Can you send your equipment to my warehouse in guangzhou?	YES.
13	How long it takes you to provide the designing options for us?	3 days at most.
14	What is your products standardization?	AWWA BS AIP WRAS FM.
15	How do you pack the equipment?	Negotiate with the customer.
16	Can you can design the equipment according to our size?	YES.
17	How many years have your company made this kind of equipment?	5 years.
18	Which certificate do you have for your equipment?	FM.
19	How many staffs do you have in your factory?	200
20	Do you have any agent in our country?	NONE.
21	Do you have any real project pictures of the equipment?	YES.
22	How far is your factory from the city hotel?	10 km.
23	How far is your factory from the airport?	10 km.

24	How long it will take from guangzhou to your factory?	5 hours.
25	Where is your factory located?	Weifang City, Shandong province.
26	Do you provide free spare parts?	It depends.
27	What is the age range for your products?	Everyone.
28	Do you have detailed and professional installation manual?	YES.
29	If OEM is acceptable?	YES.
30	Do you provide sample? Free or charge?	It depends.
31	What is your term of payment?	30% payment in advance, 70% paid before shipment.
32	What is your MOQ?	One container.
33	Are you a trading company or a manufacturer?	Trade and Industry combination group company.
34	How long is your delivery time?	25-40 days.

With a sound business credit, excellent after-sales service and modern manufacturing facilities, we have earned an excellent reputation among our customers across the world for Big discounting China Non Rising Stem Groove End Resilient Seated Gate Valve, Welcome to go to our firm and manufacturing unit. Be sure to really feel free to get in touch with us in the event you need any further more assistance. Big discounting China Non Rising Stem Groove End Resilient Seated Gate, Nrs Gate Valve, Customer's satisfaction is always our quest, creating value for customers is always our duty, a long term mutual-beneficial business relationship is what we're doing for. We've been an absolutely reliable partner in your case in China. Of course, other services, like consulting, can be offered too.