

10.1Inch 800*1280 Mipi Interface Full Viewing Angle IPS TFT LCD Display Module with Capacitive Touch Panel

The following is about 10.1Inch 800*1280 Mipi Interface Full Viewing Angle IPS TFT LCD Display Module with Capacitive Touch Panel, I hope to help you better understand 10.1Inch 800*1280 Mipi Interface Full Viewing Angle IPS TFT LCD Display Module with Capacitive Touch Panel.

Product Description

Product instruction of the 10.1Inch 800*1280 Mipi Interface Full Viewing Angle IPS TFT LCD Display Module with Capacitive Touch Panel

We supply 10.1 inch TFT LCD Display which is a transmissive type a-Si TFT-LCD (amorphous silicon thin film transistor liquid crystal display) module, which is composed of a TFT-LCD panel, a driver circuit and a backlight unit, The panel size is 10.1 inch and the resolution is 800x1280. the panel can display up to 16M colors. The LCM can be easily accessed by LVDS interface.

Product Specification of the 10.1 inch TFT LCD Display 800x1280

No	Item	Specification	Remark
1	LCD Type	Active matrix TFT, Transmissive type	
2	Screen Size	10.1inch	
3	Resolution	IPS(800xRGBx1280)	
4	Color Number	16M	
5	Color Arrangement	RGB vertical stripes	
6	Driver IC	--	
7	Back Light	White LEDx28	

8	Viewing Direction	ALL	
9	Interface	LVDS Interface	
10	Interface Number	40 PINS FPC	
11	TouchPanel	NA	

Parameter	Specifications	Unit
Outline dimensions	143.00(W)x228.60 (H)x2.7 (T) (LCM,no include FPC)	mm
Active area	135.56(W) x216.576(H)	mm
Resolution	800xRGBx1280 dots	-
Pixel Pitch	0.0564x0.1692	mm

Production Drawing of the 10.1 inch TFT LCD Display 800x1280

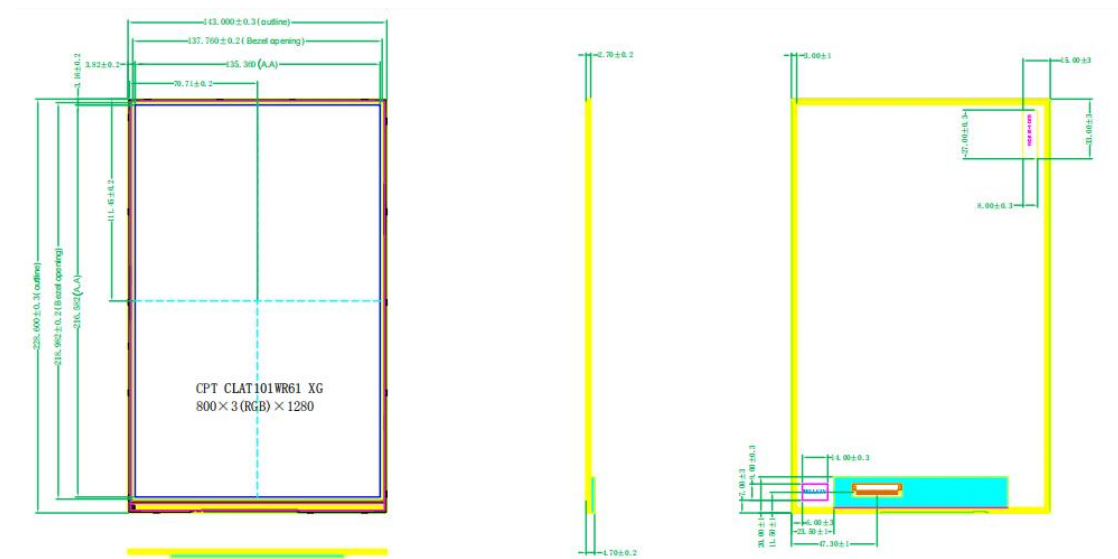

Production PINS Definition of the 10.1 inch TFT LCD Display 800x1280

Pin No	Symbol	Description
1	NC	NC
2	VCC	3.3V input
3	VCC	3.3V input

4-7	NC	NC
8	RX0N	-LVDS Differential Data Input
9	RX0P	+LVDS Differential Data Input
10	GND	GROUND
11	RX1N	-LVDS Differential Data Input
12	RX1P	+LVDS Differential Data Input
13	GND	GROUND
14	RX2N	-LVDS Differential Data Input
15	RX2P	+LVDS Differential Data Input
16	GND	GROUND
17	RXCN	-LVDS Differential Data Input
18	RX2P	+LVDS Differential Data Input
19	GND	GROUND
20	RX3N	-LVDS Differential Data Input
21	RX3P	+LVDS Differential Data Input
22-24	NC	NC
25	GND	GROUND
26-27	NC	NC
28	GND	GROUND
29-30	NC	NC
31	LEDK	Current Sink for LED String
32	LEDK	
33-34	NC	NC
35	PWM	System PWM Signal Input (+3.3V Swing)
36	LED_EN	LED enable pin (+3.3V Input)
37-38	NC	NC
39	LEDA	Anode for BLU 5-12V
40	LEDA	

Product Feature and Application of the 10.1 inch TFT LCD Display 800x1280

Standard: Computer, Office equipment, Communication equipment, Test and Measurement equipment, Machine tool, Industrial robot, Audio and Visual equipment, Other consumer products.

Product Application

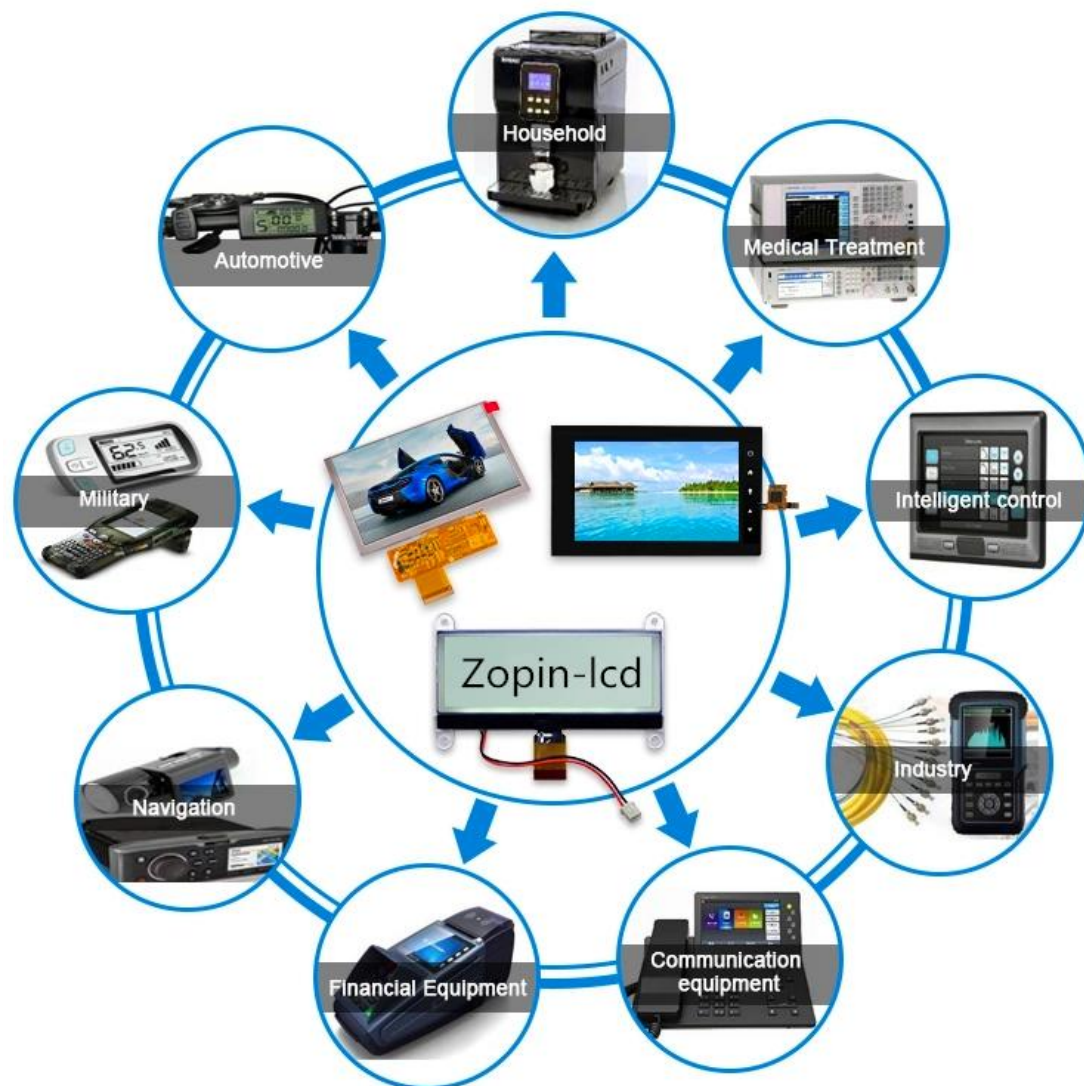

Product Quality Control of the 10.1 inch TFT LCD Display 800x1280

Before package and shipment, the original products will be tested one by one by our technicians and QC team to make sure the quality of every product is good.
We will test goods strictly according to our standard inspection before shipment.

Delivery, shipping and Severing of the 10.1 inch TFT LCD Display 800x1280

- 1). Payment Terms: T/T, Western Union.
- 2). Shipping: Prompt delivery by UPS, EMS, DHL, TNT, FedEx, or by air.
- 3). Delivery time: 3-7 days for goods in stock, 3-4 weeks for mass production goods.
- 4). Packaging Details: Packed in anti-static bags with foam box to ensure safety in transportation.
- 5). Delivery Details: 1 to 30 days. The delivery fee is up to the weight and volume of the products.
- 6). Samples: Our company offers samples for quality test or other business purposes, but we kindly ask you to pay for samples and the freight.

PACKAGE & LOGISTICS



VACANCY TRAY ADHESIVE TAPE



SHOCKPROOF & WATERPROOF



COMPLETE PACKAGE



TRANSPORTATION



SIGN FOR

Shipping&Payment



FAQ

Q: What is the MOQ?

A: Generally if you choose the different products, our minimum order qty also will be different.

Q: What about the delivery time?

A: The LCD products need 3-4 weeks to be made after receive deposit.

Q: Does your product have any warranty?

A: Yes, we offer 12 months warranty for our products. Damage due to misuse, ill treatment and unauthorized modifications and repairs are not covered by our warranty.

Q: What's your payment method?

A: We usually accept the payment methods include T/T, Western Union. 50-100% deposit in advance and balance before shipping upon the payment amount. Buyer can choose which payment ways that you accept.

Q: What's your shipping method?

A: We provide comprehensive shipping methods.

For small quantity orders we ship by UPS Air-Express, or DHL/FEDEX/TNT/EMS Express service, it is safe and fast.

For large quantity orders we ship by buyer's cargo agent in China, we can also ship by Air transportation or sea transportation.

Q: Do you offer custom solution?

A: Yes, we can offer custom solution if standard products couldn't meet buyer's requirements.

Latest News